

Description

3-piston alternating volumetric pumps for use on cleaning units and industrial systems. Hollow shaft version pump with included flange for gasoline engine ø 1"SAE J609a.
 Pump body and cover in die-cast aluminium alloy.
 Side cover incorporate oil sight glass. Oil level on pump body.
 Rear cover with oil drain outlet.
 Pistons driven by crank-connecting rod mechanism.
 Pump shaft in pressed high-strength steel.
 Oversized friction bearings.
 Connecting rods in die-cast special low-friction zinc-aluminium alloy.
 One-piece ceramic pistons.
 Pump head in pressed brass.
 Double gasket sealing system.
 Intake and delivery valves have plugs for easier maintenance.

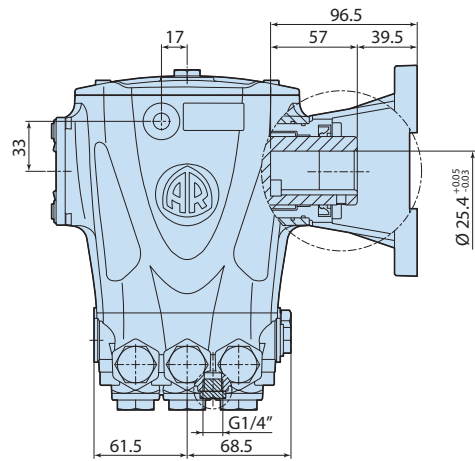

Details	Value
Category	Cleaning
Series	322 - RR, RRA, RRV
Pump type	RRV 3.5 G36 D + flange ø 1”
Versioning	D
ARCode	23791
Output (lt/min)	13.2
Output (gpm)	3.5
Pressure (bar)	250
Pressure (psi)	3600
Power (hp)	8.6
Power (kw)	6,4
RPM	3400
Weight (kg)	8

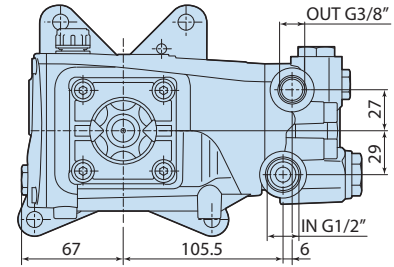
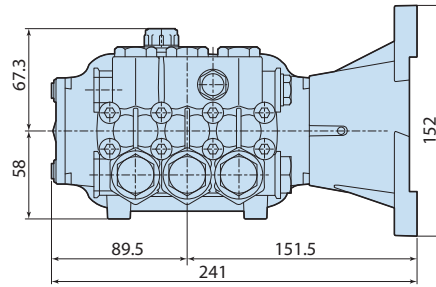
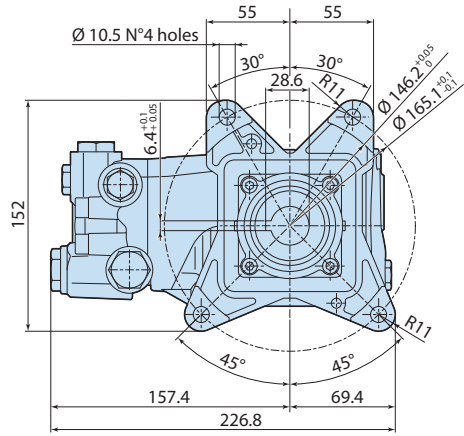

3228505