

Technical data RRV 3.5 G25 D + flange Ø 3/4" code 23788

Description

3-piston alternating volumetric pumps for use on cleaning units and industrial systems. Hollow shaft version pump with included flange for gasoline engine Ø 3/4" SAE J609a.

Pump body and cover in die-cast aluminium alloy.

Side cover incorporate oil sight glass. Oil level on pump body.

Rear cover with oil drain outlet.

Pistons driven by crank-connecting rod mechanism.

Pump shaft in pressed high-strength steel.

Oversized friction bearings.

Connecting rods in die-cast special low-friction zinc-aluminium alloy.

One-piece ceramic pistons.

Pump head in pressed brass.

Double gasket sealing system.

Intake and delivery valves have plugs for easier maintenance.



Details	Value
Category	Cleaning
Series	322 - RR, RRA, RRV
Pump type	RRV 3.5 G25 D + flange 3/4"
Versioning	D
ARCode	23788
Output (lt/min)	13.2
Output (gpm)	3.5
Pressure (bar)	170
Pressure (psi)	2500
Power (hp)	6
Power (kw)	4,5
RPM	3400
Weight (kg)	8

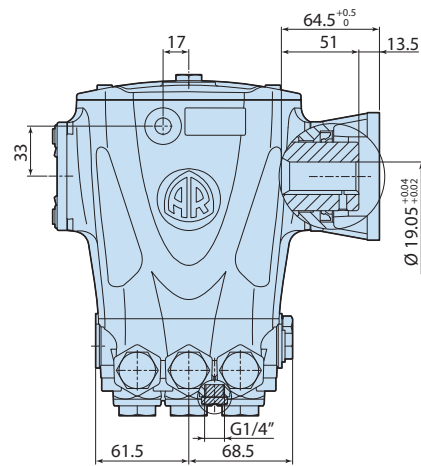
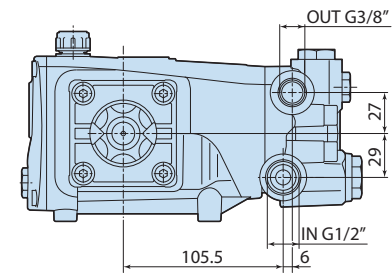
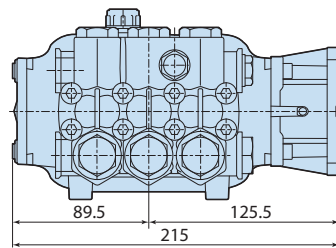
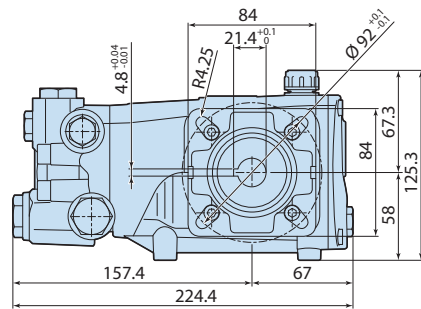

3228504