

Technical data RRA 5.5 G26 + flange ø 1"1/8 code 23784

Description

3-piston alternating volumetric pumps for use on cleaning units and industrial systems. Hollow shaft pump version with included flange for electric motor NEMA 182-184, 4 poles 60 Hz.

Pump body and cover in die-cast aluminium alloy.

Side cover incorporate oil sight glass. Oil level on pump body.

Rear cover with oil drain outlet.

Pistons driven by crank-connecting rod mechanism.

Pump shaft in pressed high-strength steel.

Oversized friction bearings.

Connecting rods in die-cast special low-friction zinc-aluminium alloy.

One-piece ceramic pistons.

Pump head in pressed brass.

Double gasket sealing system.

Intake and delivery valves have plugs for easier maintenance.



Details	Value
Category	Cleaning
Series	322 - RR, RRA, RRV
Pump type	RRA 5.5 G26 + flange ø 1"1/8
Versioning	E
ARCode	23784
Output (lt/min)	20,8
Output (gpm)	5.5
Pressure (bar)	180
Pressure (psi)	2600
Power (hp)	10
Power (kw)	7,5
RPM	1750
Weight (kg)	8

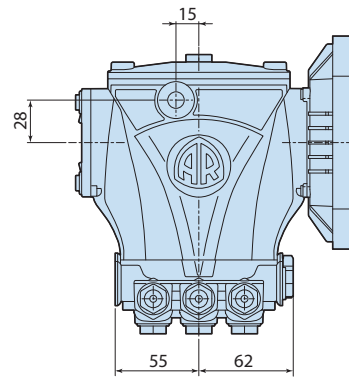
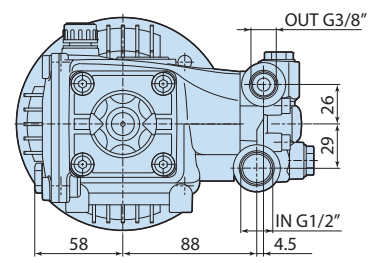
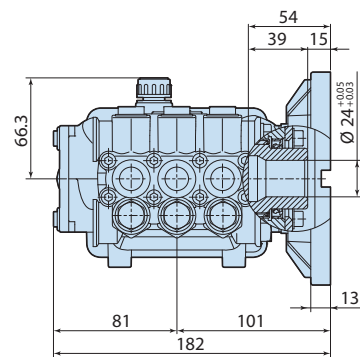
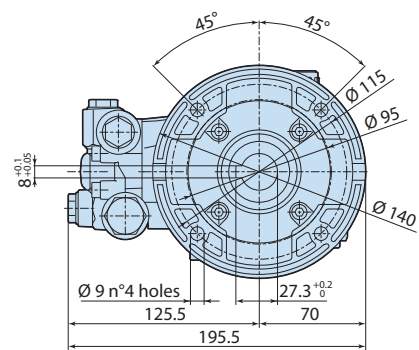

3208503