

Technical data RRA 3 G30 E + flange ø 1"1/8 code 23782

Description

3-piston alternating volumetric pumps for use on cleaning units and industrial systems. Hollow shaft pump with included flange for electric motor NEMA 182-184, 4 poles 60 Hz.
Pump body and cover in die-cast aluminium alloy.
Side cover incorporate oil sight glass. Oil level on pump body.
Rear cover with oil drain outlet.
Pistons driven by crank-connecting rod mechanism.
Pump shaft in pressed high-strength steel.
Oversized friction bearings.
Connecting rods in die-cast special low-friction zinc-aluminium alloy.
One-piece ceramic pistons.
Pump head in pressed brass.
Double gasket sealing system.
Intake and delivery valves have plugs for easier maintenance.



Details	Value
Category	Cleaning
Series	322 - RR, RRA, RRV
Pump type	RRA 3 G30 E + flange ø 1"1/8
Versioning	E
ARCode	23782
Output (lt/min)	11,4
Output (gpm)	3
Pressure (bar)	205
Pressure (psi)	3000
Power (hp)	6.2
Power (kw)	4,6
RPM	1750
Weight (kg)	8

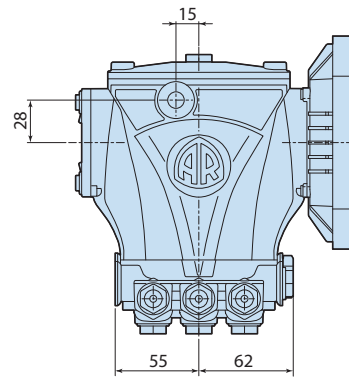
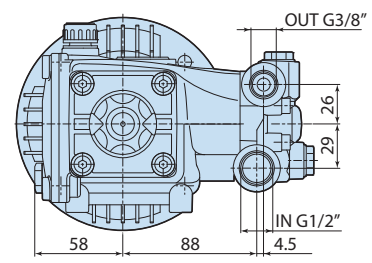
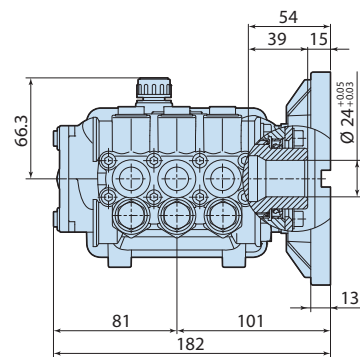
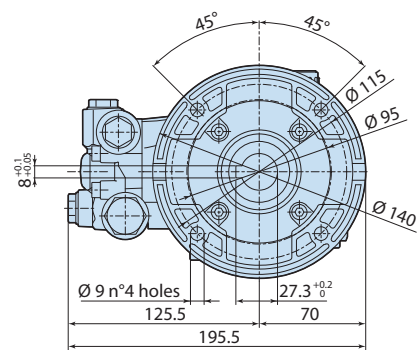

3208503