

Description

3-piston alternating volumetric pumps for use on cleaning units and industrial systems.

Coupled with flexible joint and F30 flange to electric motor 15hp 11kw 230/400V 50Hz 4P B3-B14 GR132.

Pump body and cover in die-cast aluminium alloy.

Side cover may be blind or incorporate oil sight glass.

Rear cover with oil drain outlet and sight glass.

Pistons driven by crank-connecting rod mechanism.

Pump shaft in pressed high-strength steel.

Oversized friction bearings.

Connecting rods in die-cast special low-friction zinc-aluminium alloy.

One-piece ceramic pistons.

Pump head in pressed brass.

Double gasket sealing system.

Intake and delivery valves have plugs for easier maintenance.



Details	Value
Category	Electric motor-pump units
Series	194 - HXW, HXWL, HXWA, HSXW, HSHP
Pump type	HSXW 15.35
Versioning	ET
ARCode	21066
Output (lt/min)	15.1
Output (gpm)	4
Pressure (bar)	350
Pressure (psi)	5100
Power (hp)	15
Power (kw)	11
RPM	1450
Weight (kg)	75

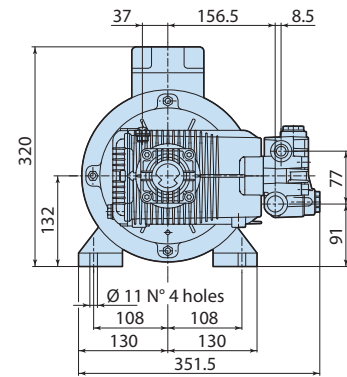
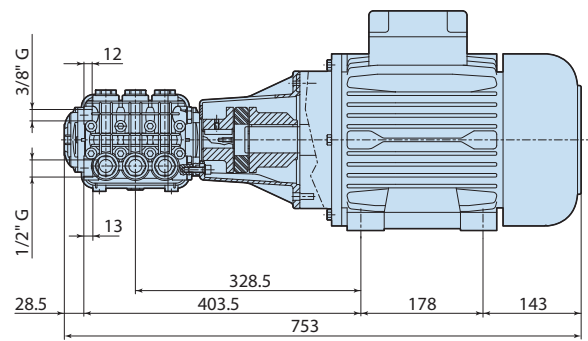

1948513